

Courses and Distances
up the River are as follow

N 50 W	24
S 84 W	59
N 65 W	20
N 43 W	63
S 81 W	10
<hr/>	
	176

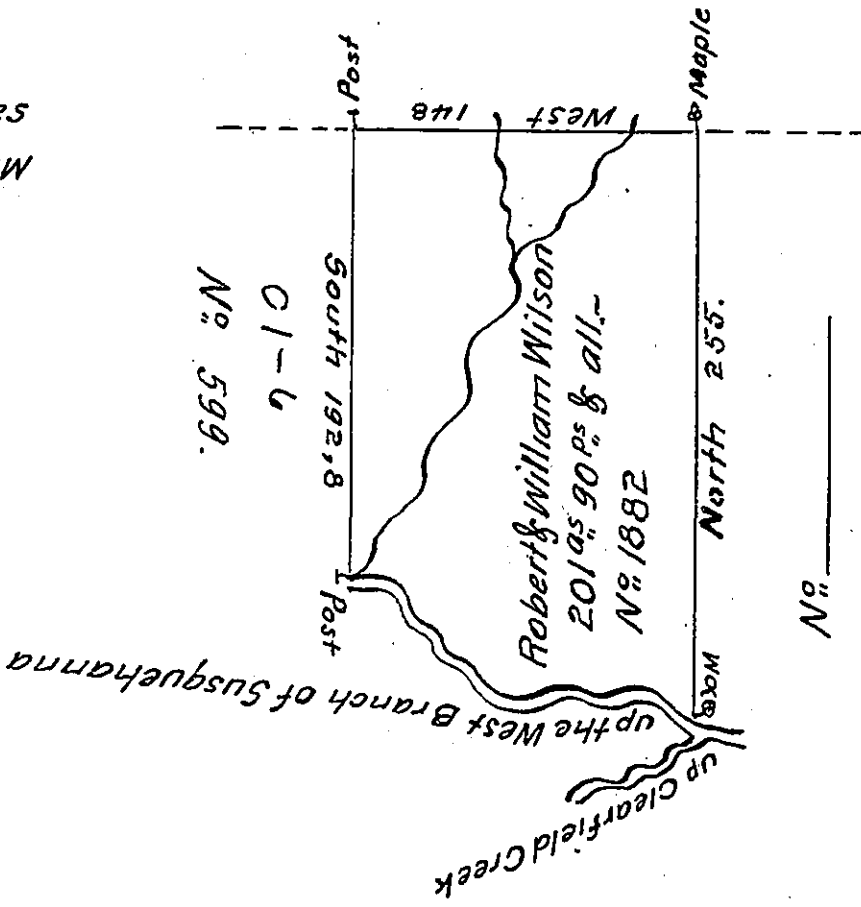

Situate on the North Side of the West Branch of Susquehanna River nearly opposit the Mouth of Clearfield Creek in North^d County containing 201^{as} - 90^{ps} and the Usual allowance for Roads. Surveyed the 28th day of December 1794. for Robert and William Wilson in pursuance of a Warrant dated the 20th Day of August 1792 and Numbered 1882

Daniel Brodhead Esq^r S.G.

John Ganan D.S.

IN TESTIMONY that the above is a copy of the original remaining on file in the Department of Internal Affairs of Pennsylvania, made comformably to an Act of Assembly approved the 16th day of February 1833, I have hereunto set my hand and caused the Seal of said Department to be affixed at Harrisburg, this thirty-first day of May 1907

Henry Horvath

Secretary of Internal Affairs.